

President's Message

Well, this has been an “interesting” year! Like many of you, the RillitoBend Board has faced many challenges to stay connected and engaged. During this virus, we have had “Zoom” meetings and a few in-person, socially-distant meetings. Here are a few of our activities:

In 2018 the City of Tucson passed Proposition 407 with approval for a \$225 million bond package to improve parks, bike boulevards and lanes, greenways, and pedestrian safety. One element of this program is the \$1.4 million six-mile Treat Avenue Bicycle Boulevard of which Cactus Boulevard is part. Our primary concern is the intersection at Cactus and Prince. Although we were unsuccessful in getting the engineers to scale down the HAWK (High-Intensity Activated CrossWalk signal device) at the west side of the intersection, we are hopeful the City will work up a design at the NE corner that will be sympathetic to our wonderful new neighborhood mural.

Cactus Boulevard is a core access road to our neighborhood, especially now with increased foot and bike traffic during this Covid-19 crisis. At last year's annual neighborhood meeting, I presented the idea of Cactus as a “Linear Zócalo.” Like a Mexican plaza (a Zócalo) yet extruded the length of Cactus Boulevard, small mini-plazas, or “Zócalets,” would be created along Cactus as places to pause and interact with neighbors. I am working with the City on this vision. Although there is no funding for the project, the concept is similar to the City's “Complete Streets Policy” (tucsonaz.gov/tdot/complete-streets-tucson) and the Living Streets Alliance initiative which includes the City's “MOVE Tucson” and the “Slow Streets” programs.

In an effort to mitigate stormwater runoff, the City has added a fee to our water bills to fund “Green Stormwater Infrastructure” projects (tucsonaz.gov/gsi). Our neighborhood is greatly affected by runoff.

We have submitted comments on behalf of the neighborhood asking that the program planners consider “...how this storm water could be used for the environmental benefit of this former riparian area that serves so many citizens who frequent our park, our public neighborhood attractions, and who walk and bicycle through the neighborhood to access the Loop. Applying some relatively simple storm water infrastructure improvements in RillitoBend could be a model showcase for the GSI program.”

It's been an honor serving as your Board president this year. I am continually reminded that we live in a remarkable neighborhood, and that, in spite of our

challenges, we have very special people working together to make our neighborhood even better. As you read through the newsletter, I hope your enthusiasm and optimism will continue to support our neighborhood association's work.



Stephen Brigham, RBNA President

ANNOUNCEMENTS

Annual RBNA Meeting

Due to the Covid-19 crisis, this year's annual RillitoBend Neighborhood Meeting has been cancelled. Notes from the 2019 RBNA Annual Meeting can be found on our website, rillitobendna.org/documents.

Annual Ice Cream Social

The Covid-19 crisis has dampened our fun, and there will be no ice cream social this fall.

A New Look for our RBNA Website

Check out our revamped website, rillitobendna.org, a source for neighborhood news, history, and documents such as the RBNA Bylaws and vision.

RillitoBend Nextdoor

Our neighborhood uses Nextdoor, a private online network in Tucson that overlays neighborhood associations in the City. With Nextdoor, one can communicate with neighbors and receive information about the community—as well as from the City such as police and health alerts, water main breaks, Census information.

To sign up, go to: nextdoor.com.

TIP: when setting up your profile, select only our neighborhood if you want to avoid many extraneous emails.

Lend A Hand (LAH) Senior Assistance

RillitoBend is one of 12 central Tucson neighborhoods that make up LAH. This volunteer non-profit organization provides free services for their senior neighbors (nine live in RBNA), helping them to stay in their homes and remain independent. Services include transportation to medical appointments and shopping, errands, regular social activities, twice monthly fresh produce deliveries, minor safe home repairs, and friendly calls and visits. LAH helps make our neighborhood better. Please consider volunteering—particularly if you can be a driver. Call 520-248-6882 or visit lahseniorhelp.org.

whatsCookin'

Need to talk, cook, or just get together for a walk? Golda Velez has begun a new app, what's cookin', that brings RillitoBend residents together in a more informal way. Visit app.whatscookin.us/?circle=rillitobend.

Rio Vista Conservation Project

Read the latest about the Rio Vista Conservation Project on our website: rillitobendna.org/news.

Planting Shade on Allen Road

Plans to shade and cool along Allen Road are underway! In collaboration with Meadowview HOA residents and RillitoBend neighbors, a native tree and native plant revegetation project is being planned along Allen Road's southern streetscape from Cactus Blvd. west to N. Avenida Arbodela. With the support of neighbors from helping with plant purchasing costs to volunteering labor to plant or irrigate, we hope to begin planting this fall when temperatures are a bit cooler.

If you are interested in helping and/or seeing more shade trees along our hot streets please contact the neighborhood board and we can discuss how to do more tree planting.

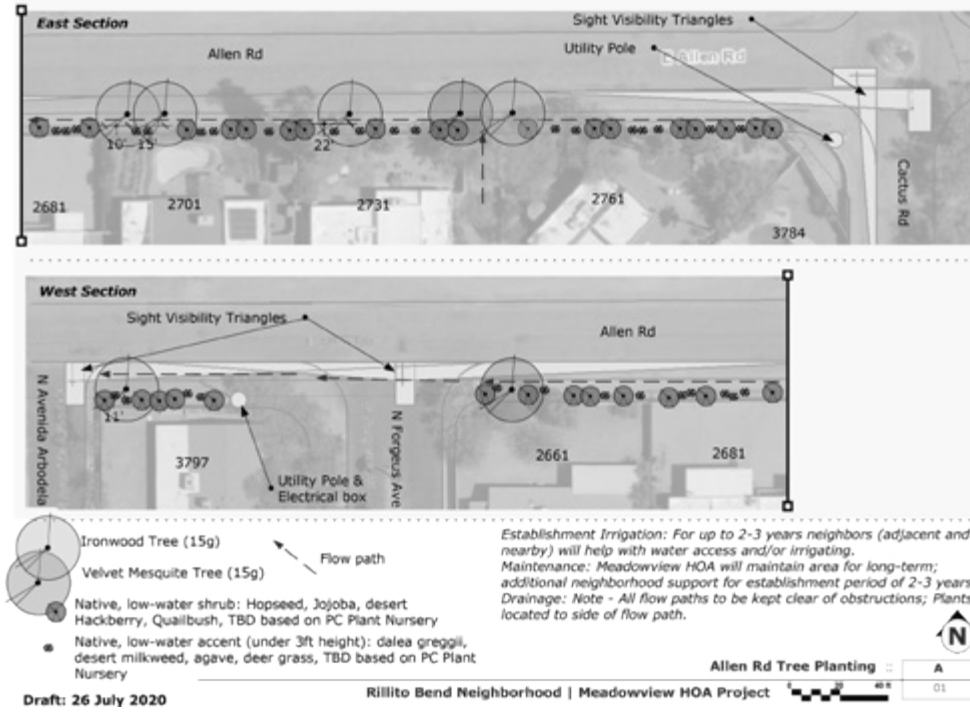

Remember when...

"When I was a bit younger, I would go out horseback riding at night through the neighborhood and down along the river. The river ran then. I remember rafting on it."

Anne Watson, who celebrated her 90th birthday this year

Did You Know?

During the 1970s, IBM planned—and later moved—their General Products Division to the Old Pueblo. Of course, there was much celebration in town because of the considerable financial stimulus created by snagging such a notable company. Around the same time, home building was booming, especially in the NW of town. When IBM decided to develop their new industrial campus along I-10 southeast of Tucson, the movers and shakers and County transportation folks thought, "Wouldn't it be wonderful to build a cross town freeway—a short cut—connecting the NW with the SE, avoiding the increasingly busy I-10 freeway?" The new "Parkway" would ease transit to and from work for residents living in the burgeoning NW.

After discarding an initial vision to create an elevated road in the Rillito River wash, the plan shifted to one that would cross the open land that is today's RioVista Natural Resources Park. The alignment would then cut across the intersection of Allen and

Cactus, and from there, the traffic would have wound through the open space where Rancho Morado now stands. And, finally, the road would be off to span the Rillito on its way east. In essence RillitoBend would have been bisected, and we would have been bidding sweet adios to our beloved neighborhood.

Happily, few people were enthusiastic about or even interested in the plan. The 13-mile Rillito-Pantano Parkway, designed to join the northwest side of town to the Tanque Verde Valley on the far east side, was sent to its final resting place when voters rejected a \$15 million bond to fund studies for the project. To our relief, it was never mentioned again.

If you were interested in reading this snippet of our RillitoBend history, soon a more complete story will be available on our website, rillitobendna.org/history.

RillitoBend Neighborhood Association Board

President: Stephen Brigham
President@RillitoBendNA.org
Vice-President: Lisa Fabrizio
Vice-President@RillitoBendNA.org
Treasurer: Terry DeCarolis
Treasurer@RillitoBendNA.org
Secretary: Kay Matthews
Secretary@RillitoBendNA.org

Members:
Linda Agen*
Mary Bird*
Lisa Fabrizio*
Nancy Fung*
Wallace Kinkade*
John Kovacic
Cass Peel*
Catlow Shipek*
Estelle Stern-Eilers
John O'Hare
Shirley Foerster
*New to Board in 2019

Committees:
Communications: Mary Bird and Wallace Kinkade
Enhancement & (Project) Maintenance: Estelle Stern-Eilers
Social: Sue DeArmond and Terry DeCarolis
Streets & Traffic Safety: John Kovacic
Neighborhood Security: John O'Hare
Nextdoor: Stephen Brigham and Pat Dunford
Project Review: Murray DeArmond and Stephen Brigham



The Fairy Kingdom

Since our beginning 97 years ago, Valley of the Moon has made our home in what has become the RillitoBend Neighborhood. Many changes have been made in response to the evil Covid-19 virus, and the Valley is now open for private tours and micro-weddings. We are preparing for theatrical entertainment in October with an Enchanted House adventure. Protective steps have been taken based on medical guidance from a volunteer physician. Touchless fixtures, sanitizer stations, an electrostatic disinfectant sprayer system and mobile handwashing unit will help ensure a safe environment.

Union Pacific Foundation is funding our SAFE PLACE Program which will provide a reduced-risk environment for the vulnerable to have contact with family and loved ones, when they are ready to take this step.

Please check for updates on our website, tucsonvalleyofthemoon.com. And, it's good to remember that now, more than ever, kindness is the real magic.

Estelle Stern-Eilers, our faithful "water wizard" and neighbor, in the Butterfly Garden



RillitoBend Neighborhood Mural Dedication, March 8, 2020

What neighborhood has a big beautiful mural as its welcome sign? RillitoBend, of course!

This 33' long mosaic mural, at the NE corner of Cactus and Prince, is the creation of Sue Ann Breems, a RillitoBend resident and artiste extraordinaire. Go to our website (rillitobendna.org/news) to read about the dedication. What luck to have been able to gather and celebrate its unveiling before the pandemic.

Visit the mural: there are so many lovely surprises to see. Try to find, for example, Sue Ann's signature tile.



Neighborhood Boundaries Review



We are working with the Campus Farm Neighborhood and the City of Tucson refining our neighborhood boundaries to ensure that all of UofA's agriculture campus is under one neighborhood—the Campus Farm Neighborhood. In the event that some UofA properties on the East side of Campbell change ownership, the properties would be transferred to the RillitoBend Neighborhood jurisdiction.

RillitoBend Neighborhood Mural Notecards for Sale

Back by popular demand, we shall be selling the RillitoBend Neighborhood Mural notecards again—in time for the holidays. Visit rillitobendna.org/news to see these colorful cards by resident photographer Vicky Strome.

Costs: \$18 for one set of 13 cards (one extra!) with envelopes. Profits directly support the RBNA. This is a one-time offer, so act now.

How? Email your name and requested number of sets to: Mary Bird at rbna@rillitobendna.org

Deadline to submit order: Monday, October 5th

Do NOT send money now. Payment is by check later.

Due to Covid-19 and reduce handling, the cards will come flat. They are scored and can be easily folded.



Planning and Development Services Dept.
 P.O. Box 27210
 Tucson, AZ 85726-7210

PRSR STD
 US POSTAGE
PAID
 TUCSON AZ
 PERMIT #541



Dated Material



Who To Call

Important Contacts for the City of Tucson

Suspicious activity, police emergency	911
Police non-emergency	520-791-4444
tucsonaz.gov/police	
Community Service Officer (CSO) Renet Martin	520-837-7428
Renet.Martin@Tucsonaz.gov	
Cars parked in City's right-of-way	520-791-5071
Garbage cans left out at the curb	520-791-3171
Graffiti removal hotline	520-792-2489
Junk vehicles, excessive yard sales, weeds	520-791-5843
Pima Animal Care Center	520-243-5900
Potholes	520-791-3154
Shopping cart pick-up	1-800-THE-CART
Ward 3 Office	520-791-4711
Water main break	520-791-4133

"The City of Tucson, its officers and employees, its Planning and Development Services Department and all other offices neither agrees nor disagrees with the views expressed or implied in this communication or any referenced websites and are not therefore responsible. The distribution requester is solely responsible."

The City of Tucson has paid for the printing and distribution of this newsletter. Thank you, Tucson!

Contact the RBNA at rbna@rillitobendna.org